

Dacobas – Lochblech-Rückwand

Dacobas – Perforated rear panel

Dacobas – Panneau arrière en tôle perforée

Assembly Instructions

1 Allgemeine Hinweise

Weitere Dokumentation beachten



Achtung!
Montageanleitung „Dacobas – Arbeitsplatz“ oder „Dacobas – Leitwartentisch“ unbedingt beachten.

Gültigkeit
Diese Anleitung gilt für folgende Dacobas-Komponenten der Knürr AG:
– Lochblech Rückwand

Notwendiges Werkzeug
– Innensechskantschlüssel 5 mm
– Kreuzschlitzschraubendreher

General information

Refer to the other documentation

Warning
See assembly instructions “Dacobas – Workstation” or “Dacobas – Control room desk”.

Validity
This document applies to the following Dacobas components from Knürr AG:
– Perforated rear panel

Tools required
– 5 mm Allen key
– Philips screwdriver

Consignes générales

Respecter les indications ci-dessous

Attention !
Respecter impérativement les instructions de montage “ Dacobas – Poste de travail ” ou “ Dacobas – Bureau pour poste de contrôle ”.

Validité
Le présent manuel concerne les éléments Dacobas de Knürr AG suivants :
– Panneau arrière en tôle perforée

Outils nécessaires
– clé Allen 5 mm
– tournevis cruciforme

2 Montage

Halteprofile montieren

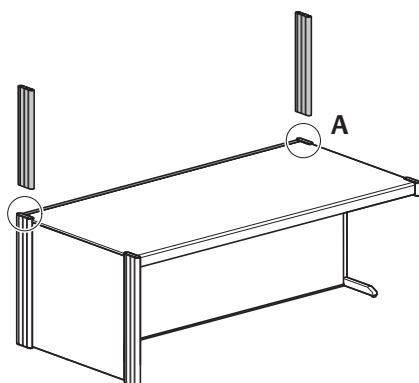

Installation

Attach the holding sections

Montage

Montage des profilés de maintien

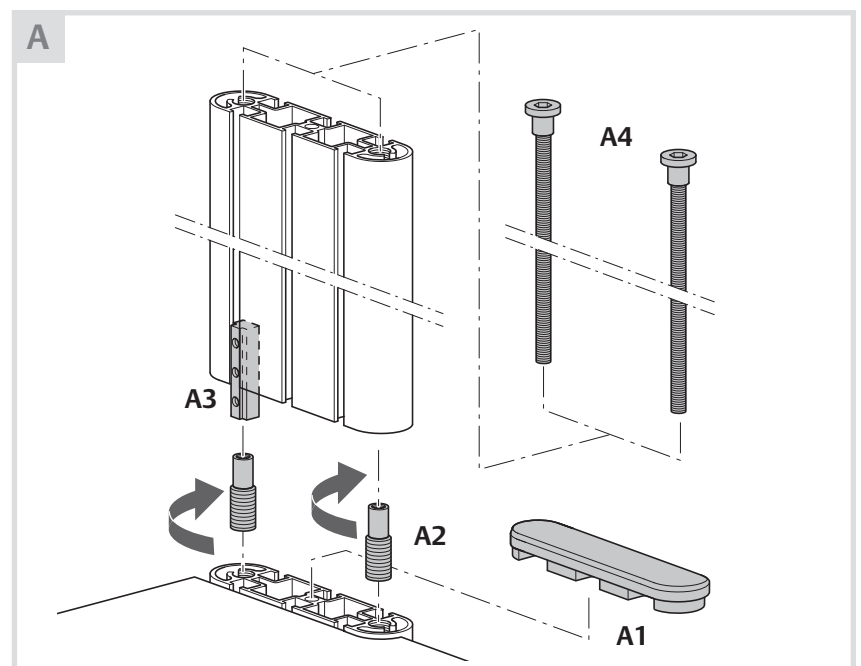

Dacobas Rückwand

Dacobas rear panel

Panneau arrière Dacobas

DEUTSCH

ENGLISH

FRANÇAIS

- Auf richtige Einbaulage der vormontierten Gewindeleiste A3 achten!

- Ensure that the ready-fitted thread strip A3 is in the correct position.

- Veiller à ce que la position de montage de la barre filetée A3 prémontée soit correcte !

Rückwand montieren

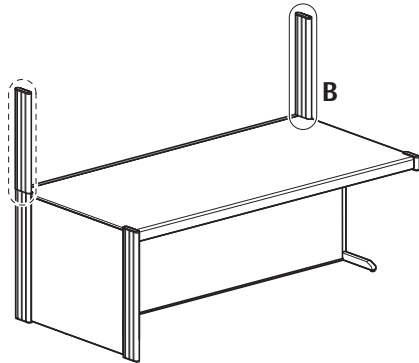

Attach the rear panel

Montage du panneau arrière

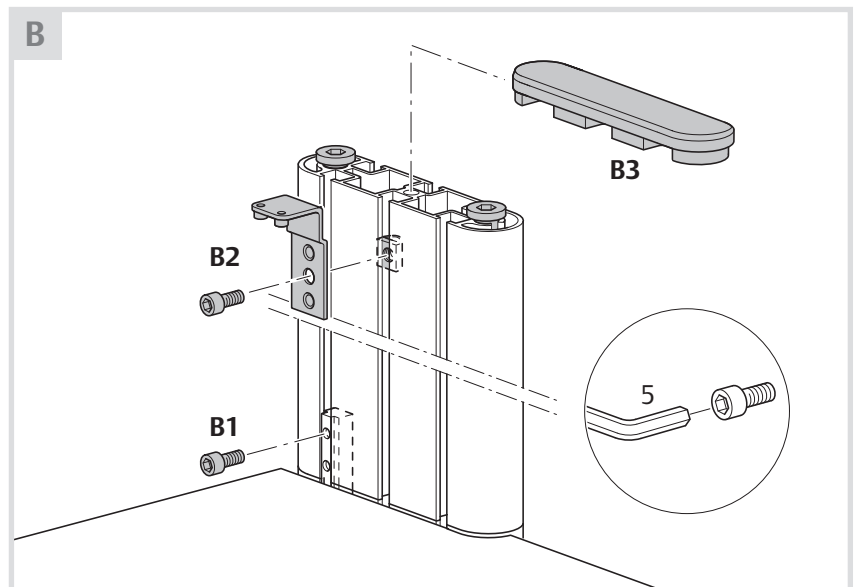

- Schrauben B1 noch nicht festziehen!

- Do not tighten screws B1 yet.

- Ne pas bloquer encore les vis B1 !

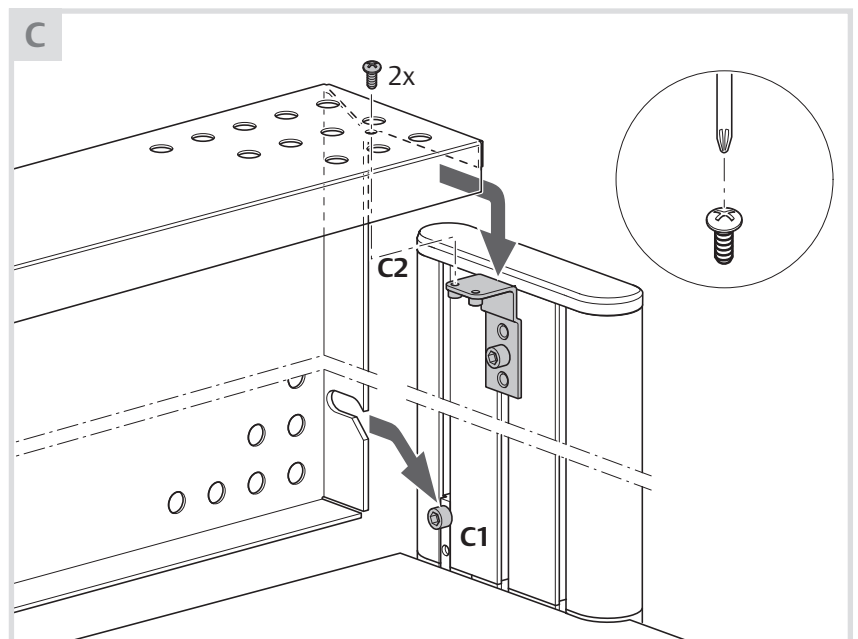
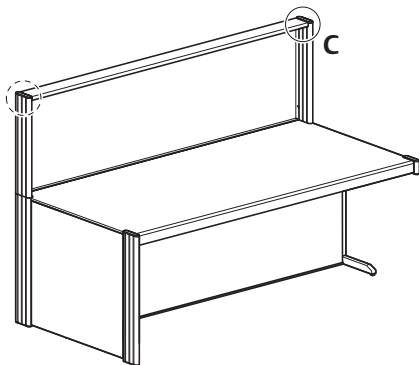

- Schrauben C1 auf beiden Seiten festziehen.

- Fasten screws C1 on both sides.

- Serrer à bloc les vis C1 des deux côtés.

3 Montage für Trapez-Wanddeckteil

Stützfuß wechseln

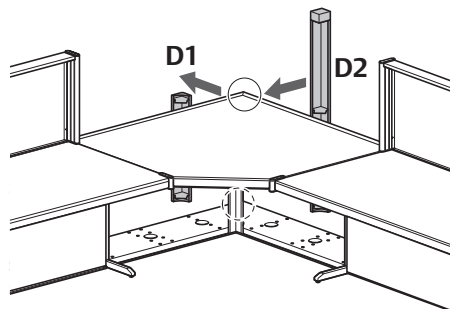

- Höheren Stützfuß auf gleiche Weise befestigen D2.

Rückwand montieren

- In den Profilen E1 Winkel und Schrauben vorbereiten (2B), Rückwand einhängen und befestigen (2C).

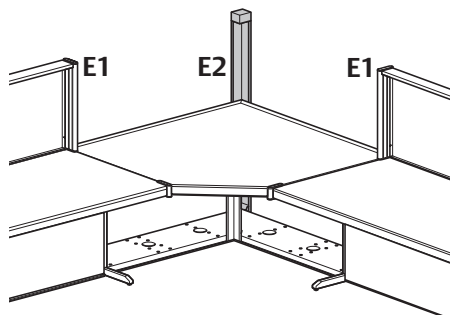

Trapezoidal wall cover assembly

Replace the support foot

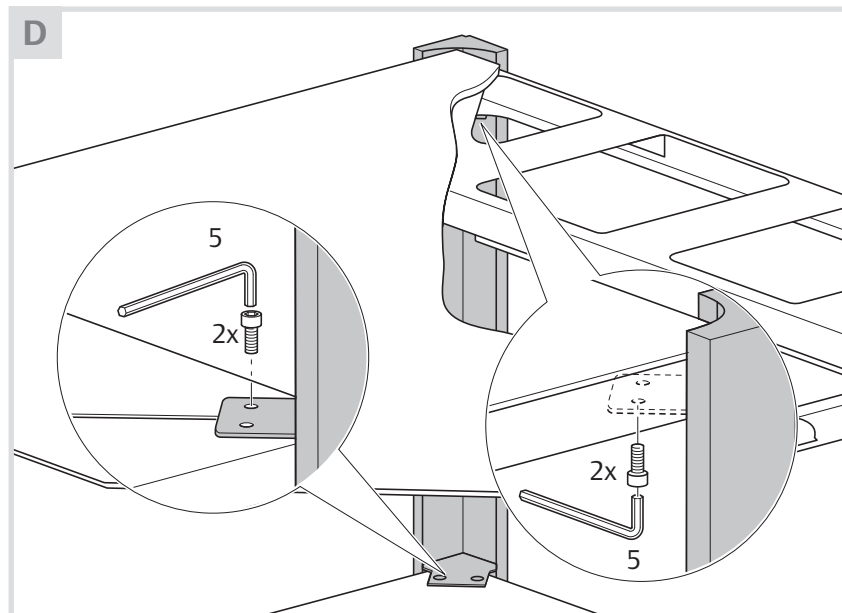

- Fasten the higher support foot D2 in the same way.

Fit the rear panel

- Prepare the angle bracket and screws in sections E1 (2B), insert the rear panel and secure it (2C).

Montage pour l'élément d'angle mural trapézoïdal

Remplacement du pied d'appui

- Fixer de la même manière le pied d'appui plus haut D2.

Montage du panneau arrière

- Préparer l'équerre et les vis dans les profilés E1 (2B), accrocher et fixer le panneau arrière (2C).

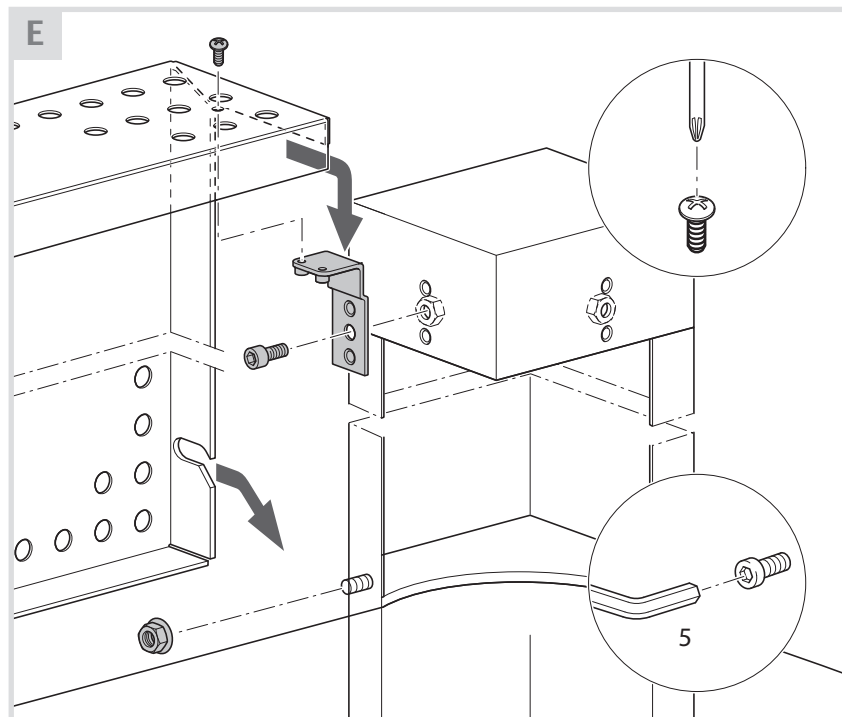

Emerson Network Power is the global technology leader in numerous areas, and a recognized expert in helping to secure business-critical processes, and therefore contributes to "business-critical continuity." A whole range of the most varied applications, including the tried and tested Knürr rack system solutions and the accompanying thermal management, ensures the required network stability with maximum technological adaptability at the same time.

Knürr system solutions in the world of information and network technology are part of an adaptive architecture from Emerson Network Power, which flexibly adapts to changes concerning security, high-density and all associated capacities. Companies are provided sustainable and long-term benefits from the high IT availability, operative flexibility and impressive reduction in investment and operating costs.

The Knürr Technical Furniture business unit develops, produces and distributes technical workstation systems for control consoles, operation control centers and electronics labs, as well as mobile equipment carriers for the automotive and medical technology industries.

Knürr AG is recognized around the world as one of the leading developers, manufacturers and distributors of rack and enclosure platforms in the indoor and outdoor area, including all relevant active/passive components in 19" construction and the technologies associated with it. Knürr is part of Emerson Network Power.

Knürr is certified in accordance with EN ISO 9001 and EN ISO 14001, and its quality management continuously guarantees the highest standards in all areas of the company.

Emerson Network Power

The global leader in enabling business-critical continuity

- AC Power Systems
- Embedded Power
- Power Switching & Controls
- Site Monitoring
- Connectivity
- Integrated Cabinet Solutions
- Precision Cooling
- Surge & Signal Protection
- DC Power Systems
- Outside Plant
- Services
- Rack & Enclosure Systems

Knürr logo, Emerson Network Power and the Emerson Network Power logo are trademarks and service marks of Emerson Electric Co. ©2008 Emerson Electric Co.

Knürr AG Global Headquarters

Mariakirchener Straße 38
94424 Arnstorf • Germany
Tel. +49 (0) 87 23/27-0
Fax +49 (0) 87 23/27-154
info@knuerr.com
www.knuerr.com

Knürr Technical Furniture GmbH Business Unit

Hauptstraße 35
94439 Münchsdorf • Germany
Tel. +49 (0) 87 23/28-0
Fax +49 (0) 87 23/28-138
www.technical-furniture.com

While every precaution has been taken to ensure accuracy and completeness in this literature, Knürr AG assumes no responsibility, and disclaims all liability for damage resulting from use of this information or for any errors or omissions.

©2008 Knürr AG. All rights reserved throughout the world. Specifications subject to change without notice.

All names referred to are trademarks or registered trademarks of their respective owners.

©Knürr and the Knürr logo are registered trademarks of Knürr AG.

EmersonNetworkPower.com